

RICARDO Engine DFAW22/S



- Engine: FAW 4DW91-29D
- Cooling Fan with fan guard and front guard
- Alternator: Single bearing, IP23, H class
- 1*12V Start Battery with connection cable
- Equipped with Shock Absorber
- Dry Air Filter, Dual Fuel Filter, Engine Oil Filter Coolant Filter
- Standard Control Panel, Circuit Breaker
- Storage Battery and battery line, Exhaust pipe
- Corrugated pipe for anti-vibration, Cone Tube, Flange, Muffler
- ATS (automatic transfer switch) receptacle
- Soundproof Enclosure/Canopy for optional
- Base fuel tank for at least 8hours running
- Equipped with an industrial muffler
- Engine oil pump
- Drainage for fuel tank
- Documents

| | |
|--------------------------------------|-----------------------|
| Generator model..... | DFAW22S |
| Rated Power..... | 16KW/20KVA |
| Standby Power..... | 17KW/22KVA |
| Voltage..... | 400/230V |
| Frequency..... | 50/60Hz |
| Speed..... | 1500rpm |
| Type..... | 3 cylinders |
| Engine Model..... | 4DW91-29D |
| Alternator..... | Stamford Chinese 184E |
| Control System..... | DKG309 |
| Circuit Breaker..... | Standard |
| ATS (automatic transfer switch)..... | Optional |
| Silent Level..... | 75dB at 7m |
| Fuel Tank Capacity..... | 8-12 hours fuel tank |
| Fuel Consumption..... | ≤0.238kgm/kw/h |

* Voltage Available:
50Hz: 380-400-415V/220-230-240V;
60Hz: 220-380-416-440-480V/110-208-220-240V
Any special voltage is also available as client's request

*Prime Power: Prime power is available for an unlimited number of annual hours in variable load Application, in accordance with GB/T2820-97 (eqv ISO8528); A 10% overload capability is available for a period of 1 hour within a 12 hour period of operation.

*Standby Power: The standby power rating is applicable for supply emergency power for the duration of a utility power interruption. No overload, utility parallel or negotiated outage Operation capability is available at the rating.

Dimensions and Weights

| Genset model | Length (L) | Width (W) | Height(H) | Weight |
|--------------|------------|-----------|-----------|--------|
| DFAW22/S | 1700mm | 900mm | 1200mm | 740kg |
| DFAW22 | 1460mm | 630mm | 1030mm | 610kg |

Notice:the size and weight is just for reference, if you

Want to confirm it, please kindly confirm it with salesman,thanks.

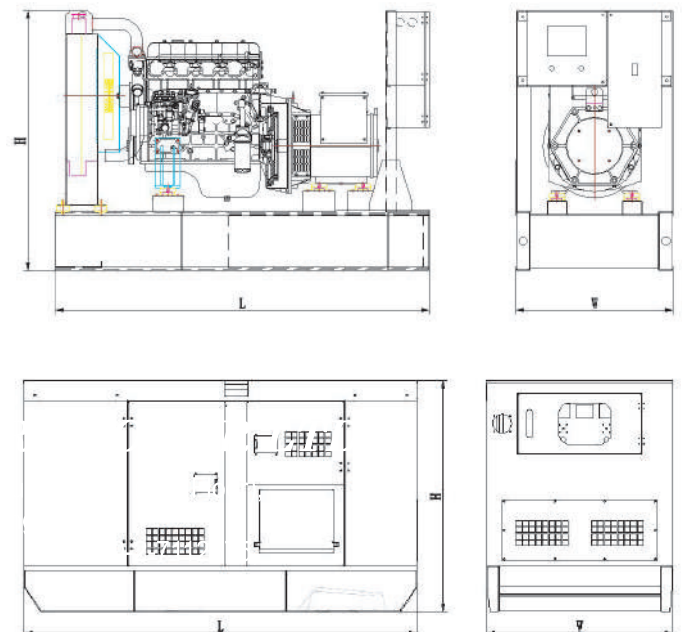

GALAXY ELECTRO POWER LTD.

219-220 Nawabpur Road, Gausia Plaza (2nd Floor),
Dhaka-1100, Bangladesh.

Tel: 880-2-7115943, 7120406, Fax: 880-2-7112675,

E-mail:galaxy@bol-online.com, Web: www.galaxyelectropower.com